

PLS-F3015 ENCLOSED 6000W FIBRE LASER CUTTING MACHINE

PLS-F3015 enclosed Fibre Laser System offers superior sheet metal cutting accuracy, greater precision, power, and speed than all its predecessors. Wide range of applications in metal processing, including: Mild Steel, Stainless Steel, Aluminium alloy etc.

Specifications

Working area	3000mm x 1500mm	Servo brand	Japan Yaskawa
Fibre Laser Power(optional)	6 kw	X axis Servo Motor Power	1.8KW x 2
X axis travel	3050mm	Y axis Servo Motor Power	0.85KW
Y axis travel	1525mm	Z axis Servo Motor Power	0.4KW
Z axis travel	280mm	Time of exchange table	10-15s(approx.)
X/Y Axial positioning accuracy	0.03mm/m	Exchange motor power	1.5KW
X/Y Axis repeated positioning accuracy	0.02mm	Maximum load	1000kg
X/Y Max Air Line Speed	140m/min	Input Power	3 Phase, 380V±5%/50-60Hz
X/Y maximum acceleration	1.4G	Software	CypCut
X axis rail	Taiwan Hiwin 35#		CypCut 8000
Y axis rail	Taiwan Hiwin 25#	Electronics Brand	Omron, Schneider
Z axis rail	Taiwan Hiwin 20#	Pneumatic Brand	SMC, AirTAC
Rack	YYC	Dust Removal	Intelligent automatic partitioning
Reducer	Japan SHIMPO	Fan power	3KW/2800RPM
Ball screw	PMI	Number of partitions	4
Machine body	16mm plate welded machine body	Cooling System	Water cooling Tongfei
Gantry	Cast Aluminium	Power Consumption	6KW
Protect cover	Yes	Overall size -Machine size	8510 x 2720 x 2200
Oil lubrication	automatic Oil lubrication	Whole machine weight ^(not including laser source, chiller, control cabinet)	8000kg

Description

- Superior edge quality plus high cutting speed
- High precision drive system using World Leader-Top Quality Rack & Pinion Drive Technologies and Gearbox
- Advanced European dual processor CNC system for axial movement
- New Smart Manager operating software
- Direct laser control with PWM (Pulse Width Modulation)
- Automatic Gas Assist System
- Windows™ Driven Control Software

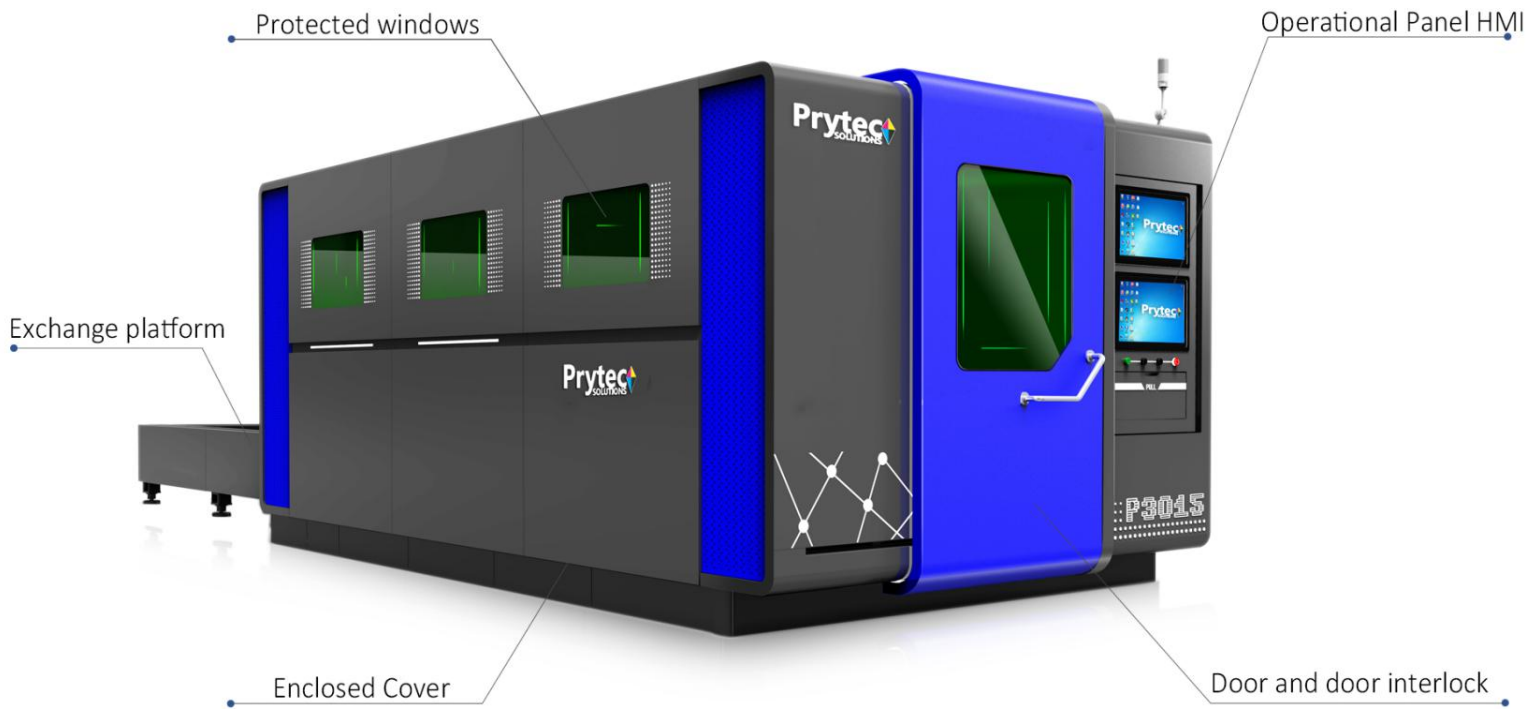

- Chain transmission ensures positive drive on exchange table
The design and manufacture of the reinforced precision welded body and two aging treatments ensure accuracy and stability for long-term operation

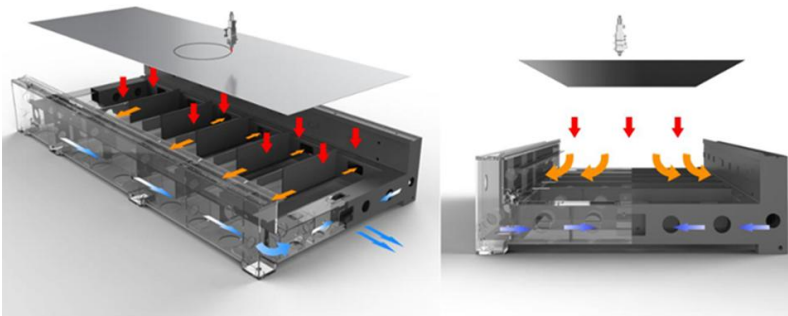

- Partitioned dust removal enhances extraction efficiency
Effectively eliminate dust and smoke during cutting
protect laser head from contamination

- Optional double cameras monitoring system
Monitor the internal and external state of the machine at any time to ensure safe cutting

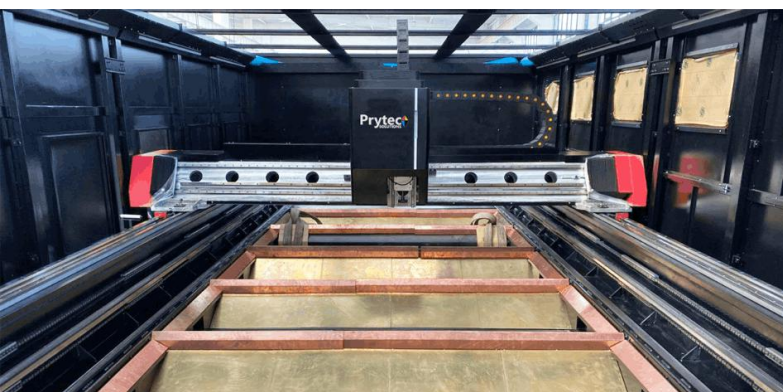
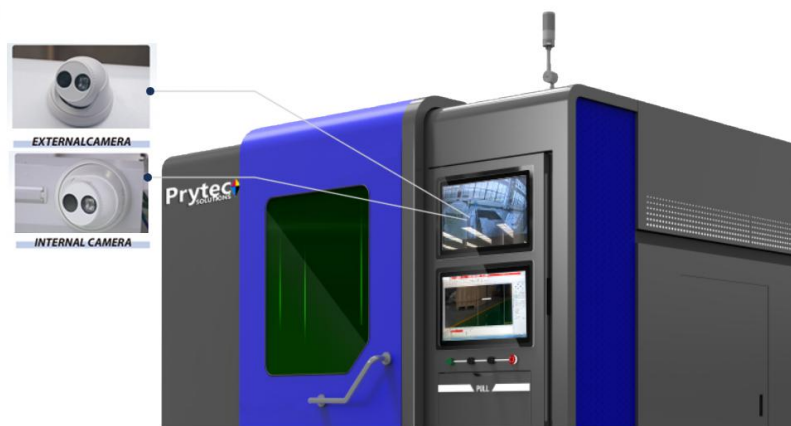

- Copper and Brass Covered Work Table
The additional heat generated by the higher wattage laser source requires a variation on the work table as temperatures reach in excess of 500 Celsius. For this reason, Copper and Brass are used in this design. This sits on a 16mm Welded Plate frame

- GERMAN PRECITEC Procutter2.0

Impresses with its increased performance and new automation features. Faster, easier, more efficient, more enduring. The ability to exchange the nozzles automatically is now provided. Automated piercing with the PierceTec technology package ensures a fast, clean and reproducible process

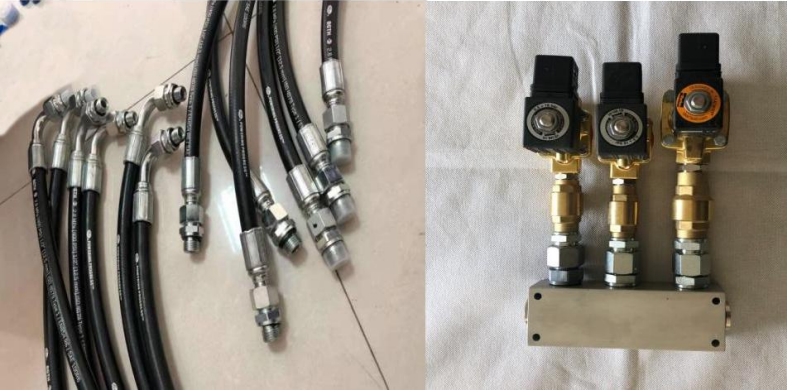

- Enhanced Gas Control System

Allows the use of higher pressures to facilitate the cutting of thicker stainless steel



Layout

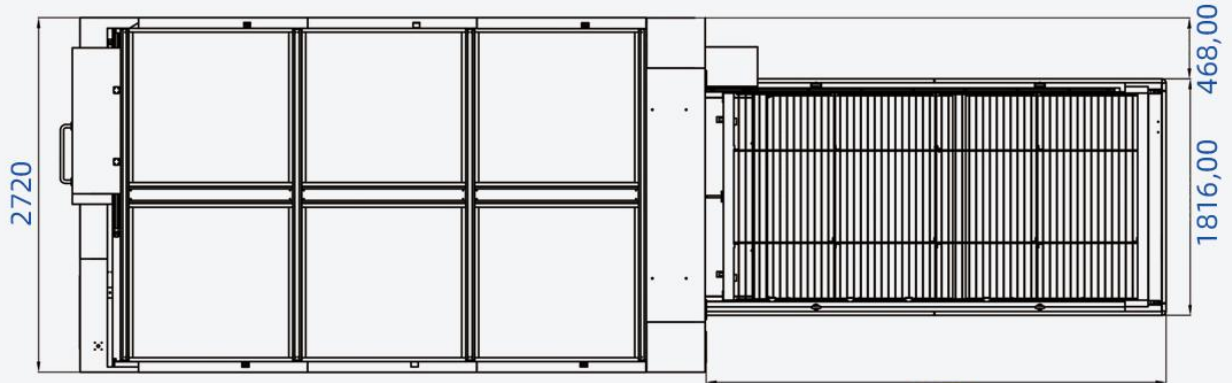
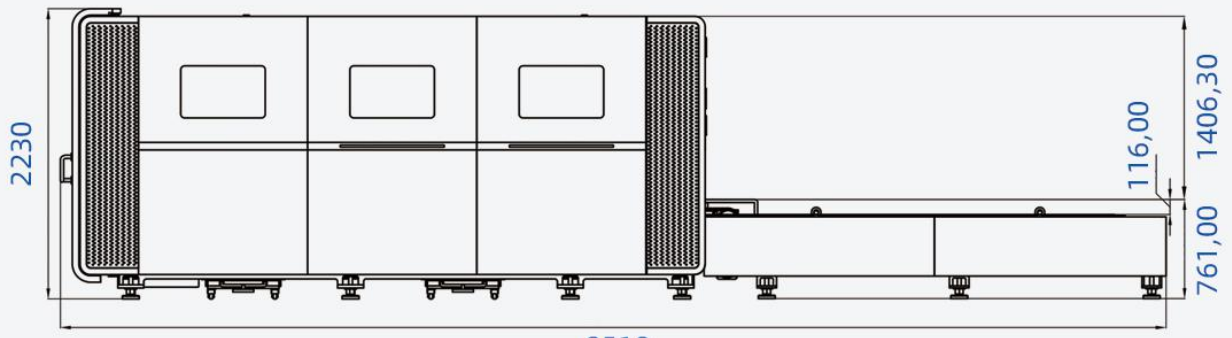

	Gas	Thickness(mm)	6000W
			Cutting Speed m/min
Carbon steel bright cut	O ₂	3	4.2~4.5
		4	3.5~3.7
		5	3.2~3.3
		6	2.6~2.8
		8	2.4~2.5
		10	2.2~2.3
		12	1.9~2.0
Carbon steel frosted surface cutting	O ₂	5	/
		6	/
		8	/
		10	/
		12	/
		14	1.3~1.5
		16	0.8~0.9
		18	0.7~0.8
		20	0.6~0.65
		22	0.55~0.6
		25	0.5~0.55
304 stainless steel cutting	N ₂	1	45~47
		2	35~37
		3	18~20
		4	14~15
		6	6~6.5
		8	4~4.2
		10	1.8~2.0
		12	1.1~1.3
		14	0.9~1.0
		16	0.8~0.85
		20	0.5~0.6

Materials without specified speed indicate that they can be processed in large quantities over a long period of time.

The material with Yellow speed indicates that it can be processed. However, due to rise in material temperature, variations in cutting pressure and plate composition, cutting quality may be compromised so a higher laser power is recommended.

The red speed indicate the material can be cut in lower volumes/batches due to heat generated



What we do

01 Listen
Analyse Customer Requirements

02 Think
Develop cost effective solutions

03 Trial
Trial solution in-show room and review with customer

04 Integrate
Integrate into customer factory

05 Train
Train customer to get optimum efficiency

06 Support
Life-cycle maintenance and support

Contact Us

Dealers in Queensland:

SignToBadge Solutions:

Office: (07) 3412 0285
Mobile: 0418 231 364

simon@snsolutions.com.au



Melbourne Office

Main Office, Factory & Showroom:

Office: (03) 8372 6444

Mobile: 0438 799 940

sales@prytec.com.au

support@prytec.com.au

Address:

Unit 1/281 Foleys Road Deer Park, Vic
Australia, 3023



Dealers in New South Wales:

TechieTools:

Office: 1300 138 486
Mobile: 0490 048 307

info@techietools.com.au

